

ZERO SET® - STEEL FORGED STEEL BODY

THREE JAW SCROLL CHUCKS WITH TOP REVERSIBLE JAWS

BTC® ZERO SET®

.0004" repeatability on duplicate parts. This accuracy is possible by having a clearance of .020" between the chuck cavity and the mounting plate hub. Opposing adjusting screws allow alignment to adjust work to "dead true" accuracy and repeatability on duplicate parts.

ZERO SET® STEEL FEATURES:

- Forged steel for higher speeds.
- Scroll hardened ground and balanced.
- Jaws ground and hardened.
- Fits all standard BTC mounting plates.
- All BTC chuck jaws are:
American Standard tongue and groove.



SUPPLIED WITH:

Chuck
Master Jaws and Top Jaws
T-Wrench
Mounting Screws

OPTIONS:

Backplates (page 8)

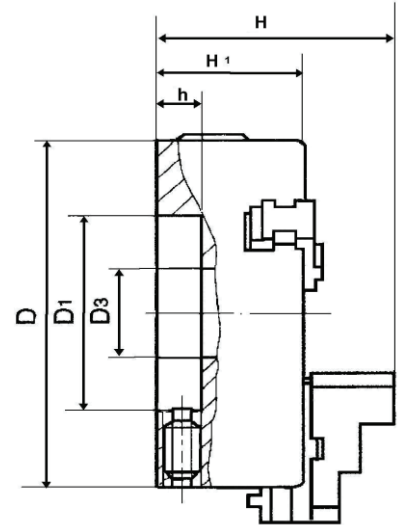
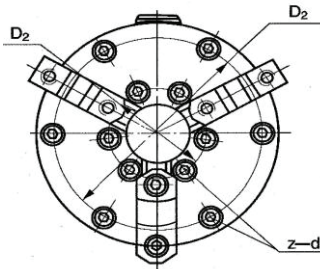

WORKHOLDING CAPACITIES AND MAXIMUM RPM LIMITS

SIZE	MODEL	OD MIN	OD MAX	ID MIN	ID MAX	MAX RPM
4"	SB1043	0.031	3.640	1.031	3.500	4400
5"	SB1054R	0.118	5.000	1.575	4.724	4000
6"	SB1063R	0.125	6.000	1.875	5.750	3700
6" ³	S1063RAS	0.125	6.000	1.875	5.750	3700
8"	SB1083R	0.200	8.250	2.125	6.750	3300
10"	SB1103R	0.500	9.360	2.937	8.718	2900
12"	SB1123R	0.500	11.312	3.281	10.125	2300
15"	SB1153R	0.562	15.000	4.000	17.748	1900

³ Am. Std. Master jaws and top jaws

PRINCIPAL SPECIFICATIONS

SIZE	MODEL	WEIGHT	D	D1	D2	D3	H	H1	h	z-d
4"	SB1043	11	4.000	2.750	3.530	1.040	3.130	2.380	0.420	3/16-24
5"	SB1054R	16	5.000	2.716	4.438	1.299	3.768	2.205	0.657	3/16-24
6" ₂	SB1063R	22	6.000	3.125	5.343	1.535	3.882	2.323	0.689	1/4-20
8" ₂	SB1083R	52	8.270	4.750	7.500	2.264	5.206	3.122	0.752	3/8-16
10" ₁	SB1103R	73	10.000	6.374	4.375	2.835	6.056	3.492	0.803	7/16-14
12" ₁	SB1123R	120	12.000	7.905	5.250	3.268	6.569	3.980	0.803	1/2-13
15" ₁	SB1153R	200	15.000	11.781	6.750	4.252	8.799	5.362	1.063	3/4-10

₁ Inner Mtg. Holes D2

₂ Outer Mtg. Holes D2