

FOUR JAW COMBINATION CHUCKS - FLATBACK SOLID JAWS OR TOP REVERSIBLE

These chucks have the features of the self centering type, as well as independent type. This enables the jaws to achieve a self centering clamping and, be adjusted separately. This can be helpful in mass production of difficult shaped work pieces.

SUPPLIED WITH:

- One piece solid reversible jaws or top reversible jaws
- T - Wrench
- Mounting Screws

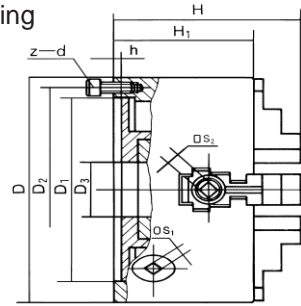

PRINCIPAL SPECIFICATIONS

Size	MODEL	WEIGHT	D	D1	D2	D3	H	H1	h	S1	S2	Z-d
6"	F064	37	6.299	5.118	5.590	1.654	3.425	4.528	0.197	0.394	0.315	3-M8
6"	F064R	37	6.299	5.118	5.590	1.654	3.425	4.528	0.197	0.394	0.315	3-M8
8"	F084	45	7.874	6.496	7.087	2.559	3.819	5.000	0.197	0.472	0.394	3-M10
8"	F084R	45	7.874	6.496	7.087	2.559	3.819	5.000	0.197	0.472	0.394	3-M10
10"	F104	68	9.843	8.110	8.898	3.150	4.016	5.591	0.197	0.472	0.394	3-M12
10"	F104R	68	9.843	8.110	8.898	3.150	4.016	5.591	0.197	0.472	0.394	3-M12
12"	F124	106	12.795	10.709	11.654	3.937	4.724	6.417	0.236	0.512	0.472	3-M16
12"	F124R	106	12.795	10.709	11.654	3.937	4.724	6.417	0.236	0.512	0.472	3-M16

"R" Designates top reversible jaws.

FOUR JAW SELF CENTERING SCROLL CHUCKS - FLATBACK SOLID JAWS OR TOP REVERSIBLE JAWS

Caution: Jaws can not be operated separately

These chucks have jaws that are operated on a scroll. Not to be confused with four jaw independent chucks.

SUPPLIED WITH:

- 2 sets of hard jaws (1 internal and 1 external) or top reversible jaws
- T-Wrench
- Mounting screws

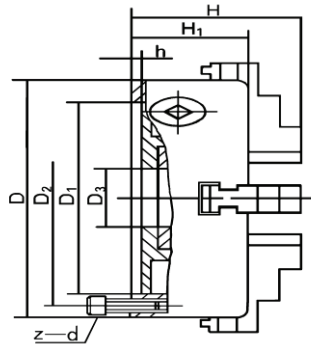

PRINCIPAL SPECIFICATIONS

SIZE	MODEL	WEIGHT	D	D1	D2	D3	H	H1	h	Z-d
5"	7054	18	5.118	3.937	4.528	1.181	3.386	2.362	0.138	3-M8
6"	7064	22	6.299	5.118	5.590	1.575	3.740	2.559	0.197	3-M8
6"	7064R	22	6.299	5.118	5.590	1.575	4.291	2.559	0.197	3-M8
8"	7084	34	7.874	6.496	7.087	2.559	4.291	2.953	0.197	3-M10
8"	7084R	34	7.874	6.496	7.087	2.559	4.803	2.953	0.197	3-M10
10"	7104	58	9.843	8.110	8.898	3.150	4.724	3.150	0.197	3-M12
10"	7104R	51	9.843	8.110	8.898	3.150	5.354	3.150	0.197	3-M12
12"	7124R	104	12.795	10.709	11.654	3.937	6.673	3.780	0.472	3-M16
15"	7154R	140	14.961	12.795	13.780	5.315	6.752	3.858	0.236	3-M16
20"	7204R	265	19.685	17.323	18.307	8.268	7.953	4.528	0.236	6-M16
25"	7254R	467	24.803	22.047	23.425	10.630	8.582	5.256	0.276	6-M16

"R" Designates top reversible jaws.