

## THREE JAW SELF CENTERING SCROLL CHUCKS TYPE "A" MOUNT - TOP REVERSIBLE JAWS

American standard two-piece tongue & groove Jaws.  
Scroll and jaws hardened and ground.  
Semi-steel body.

### SUPPLIED WITH:

Master jaws and top jaws.  
T-Wrench  
Mounting screws

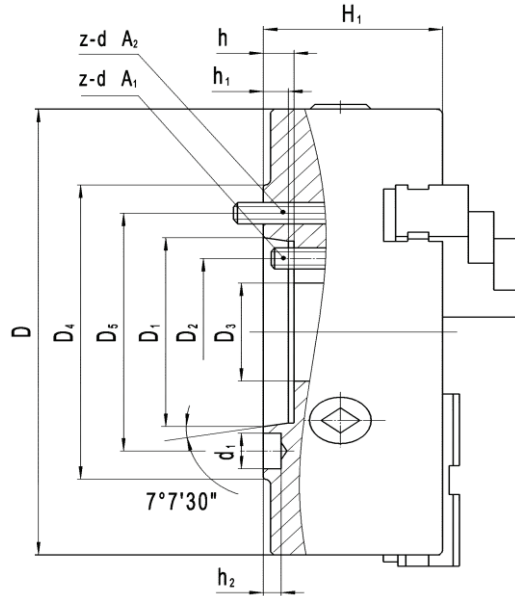

### PRINCIPAL SPECIFICATIONS

#### STYLE A1 (USE INNER TAPPED HOLES)

Size	MODEL	SPINDLE	WEIGHT	D	D1	D2	D3	D4	H1	h	h1	h2	d1	Z-d
8"	<a href="#">6083A5R</a>	A1-5	47	7.874	3.250	2.437	1.575	5.236	3.307	0.563	0.472	0.256	0.642	3-M10
10"	<a href="#">6103A6R</a>	A1-6	74	9.843	4.188	3.252	2.165	6.496	3.661	0.625	0.512	0.256	0.768	6-M12
12"	<a href="#">6123A6R</a>	A1-6	142	12.795	4.188	3.252	2.165	6.496	4.173	0.625	0.512	0.256	0.768	6-M12
12"	<a href="#">6123A8R</a>	A1-8	142	12.795	5.500	4.374	3.071	8.268	4.173	0.687	0.551	0.315	0.953	6-M16
20"	<a href="#">6203A15R</a>	A1-15	320	19.685	11.251	9.748	7.874	14.961	5.315	0.813	0.669	0.394	1.406	6-M24
25"	<a href="#">6253A20R</a>	A1-20	530	24.803	16.251	14.500	12.500	20.500	5.591	0.829	0.748	0.394	1.657	6-M24

Although an A1 type spindle nose has both inner and outer tapped holes,  
These chucks utilize the inner holes, and will **NOT** fit on an A2 type spindle.

### PRINCIPAL SPECIFICATIONS

#### STYLE A2 (USE OUTER TAPPED HOLES)

Size	MODEL	SPINDLE	WEIGHT	D	D1	D3	D4	D5	H1	h	h1	h2	d1	Z-d
8" <sub>1</sub> A	<a href="#">6083A25SR</a>	A2-5	47	7.874	3.250	2.559	5.236	4.126	3.733	0.563	0.472	0.256	0.642	6-M10
8" <sub>1</sub> A	<a href="#">6083A26SR</a>	A2-6	47	7.874	4.188	2.559	6.496	5.252	4.180	0.625	0.512	0.256	0.768	6-M12
8"	<a href="#">6083A24R</a>	A2-4	47	7.874	2.500	2.362	4.252	3.252	3.386	/	0.394	0.256	0.579	3-M10
10" <sub>1</sub>	<a href="#">6103A26R</a>	A2-6	74	9.843	4.188	3.150	6.496	5.252	3.661	0.625	0.512	0.256	0.768	6-M12
15" <sub>1</sub>	<a href="#">6153A28R</a>	A2-8	142	14.96	5.500	5.315	8.268	6.748	4.875	0.687	0.630	0.315	0.953	6-M16
15" <sub>1</sub>	<a href="#">6153A211R</a>	A2-11	142	14.96	7.751	5.315	11.024	9.252	4.875	0.750	0.630	0.394	1.157	6-M20
20"	<a href="#">6203A28R</a>	A2-8	320	19.685	5.500	5.354	8.268	6.748	5.315	0.787	0.630	0.394	0.953	6-M16
20"	<a href="#">6203A211R</a>	A2-11	320	19.685	7.751	7.480	11.024	9.252	5.315	0.787	0.630	0.394	1.157	6-M20
25"	<a href="#">6253A211R</a>	A2-11	530	24.803	7.751	7.500	11.024	9.252	5.591	0.087	0.630	0.394	1.157	6-M20
25"	<a href="#">6253A215R</a>	A2-15	530	24.803	11.251	10.236	14.961	13.000	5.591	0.827	0.669	0.394	1.406	6-M24

<sub>1</sub> Requires mounting plate (included)      A High speed steel body

These chucks use the outer tapped holes, and will fit on either A1 or A2 type spindles.

SEE PAGE 23 FOR REPLACEMENT PARTS

0.003" TIR repeatability and meet ASA specifications on duplicate parts for chucks through 12"