

Pneumatic Spring Power Chucks

Heavy Duty - Large Thru Hole

Pneumatic Open - Spring Clamp

33.5" (850mm) Diameter with 14.75" (375mm) Bore.

23.62" (600mm) Diameter with 10.83" (275mm) Bore.

SPRING CHUCK FEATURES:

- Solid steel body and parts.
- Ground and hardened body and parts.
- Same mounting as other popular front mount chucks.
- Removable spring columns for pressure adjustment.
- All mounting styles available.
- Other sizes on application.

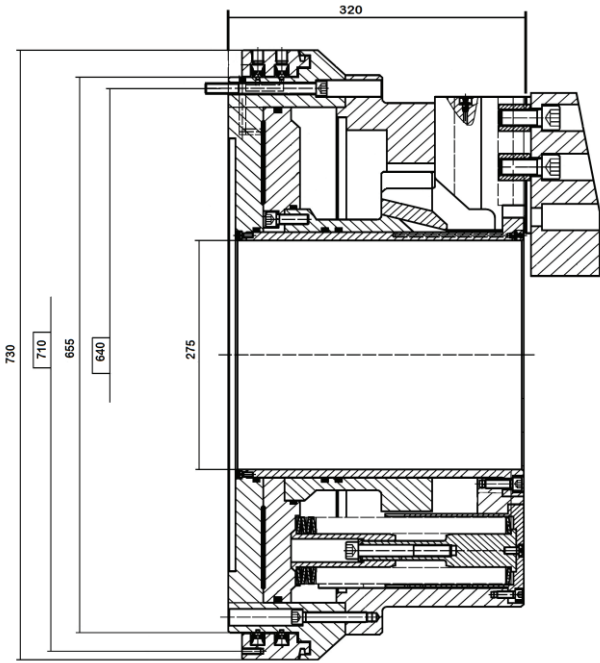
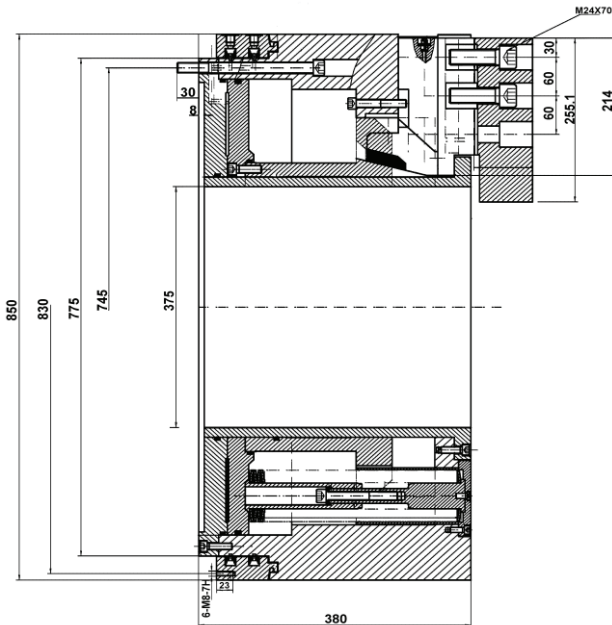

Jaws have 70% faster opening and closing speed than air chucks

- Chuck diameter: 33 1/2" (850mm).
- Bore diameter: 14.75" (375mm).
- Rapid jaw stroke per jaw .590" (15mm).
- Clamp jaw stroke per jaw: .472" (12mm).
- Jaw serrations: 3/32" x 90°.
- Min. operating pressure: 75 psi.
- Maximum RPM: 700
- Part Number: SC1-850

- Chuck diameter: 23.62" (600mm).
- Bore diameter: 10.83" (275mm).
- Rapid jaw stroke per jaw .665" (16.9mm).
- Clamp jaw stroke per jaw: .335" (8.5mm).
- Jaw serrations: 3/32" x 90°.
- Min. operating pressure: 75 psi.
- Maximum RPM: 900
- Part Number: SC1-600